



Channel Nut - No Spring



- For all channel sizes
- 7404 can not be used with 13/16" & 1" channel
- Zinc Electroplate Finish

DIMENSIONS = INCHES

CAT. NO.	THREAD	THICKNESS	BOX QTY
17400	1/4"-20	.25"	100
17402	3/8"-16	.37"	100
17404	1/2"-13	.50"	100

Channel Nut - Short Spring



- For 13/16" & 1" channel
- Zinc Electroplate Finish

DIMENSIONS = INCHES

CAT. NO.	THREAD	THICKNESS	BOX QTY
17412	1/4"-20	.25"	100
17420	3/8"-16	.37"	100

Channel Nut Regular Spring

- For 1-3/8" & 1-5/8" channel
- Zinc Electroplate Finish

DIMENSIONS = INCHES

CAT. NO.	THREAD	THICKNESS	BOX QTY
17430	1/4"-20	.25"	100
17438	3/8"-16	.37"	100
17442	1/2"-13	.50"	100



Post Base Single Channel 2 Hole Standard Strut 1-5/8"

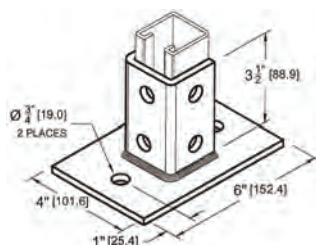

- Secures Strut Assembly to Floor or other Surface
- Galvanized Steel
- 2 Mounting Holes
- 4" X 6" Base

CAT. NO.	BOX QTY
17450	5

Post Base Single Channel 4 Hole Standard Strut 1-5/8"

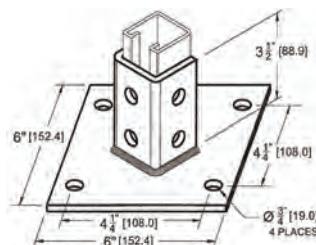

- Secures Strut Assembly to Floor or other Surface
- Galvanized Steel
- 4 Mounting Holes
- Corner Orientation
- 6" X 6" Base

CAT. NO.	BOX QTY
17452	5

Post Base Single Channel 4 Hole Square Strut 1-5/8"

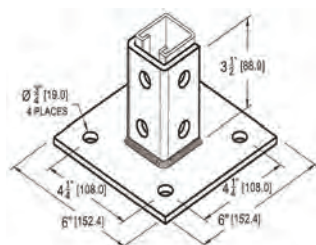

- Secures Strut Assembly to Floor or other Surface
- Galvanized Steel
- 4 Mounting Holes
- Side Orientation
- 6" X 6" Base

CAT. NO.	BOX QTY
17454	5